



3 Woodlands View

Herbert Road
High Wycombe
HP13 7HH

Monthly Rental Of £975

- Well presented, refurbished 1 bedroom flat
- Modern fitted kitchen and bathroom
- Electric heating and double glazed windows with far reaching woodland views
- Allocated parking and well maintained communal gardens
- Redecorated and re carpeted throughout
- EPC Rating: C, Council Tax Band: B



T: 01494 358358

E: lettings@wyeres.co.uk

W: www.wyeres.co.uk

3 Woodlands View Herbert Road High Wycombe HP13 7HH

PROPERTY FACTS

Communal Entrance Hall | Stairs To First Floor Landing | Front Door | Entrance Hall | Lounge With Far Reaching Woodland Views | Modern Fitted Kitchen | Master Bedroom | Modern White Bathroom Suite | Electric Heating | Double Glazed Windows | Small Development Close To Open Woodland | Allocated Parking | Communal Gardens | Redecorated And New carpets Throughout |

A refurbished and well presented one bedroom first floor apartment set in a quiet location to the east side of High Wycombe. The property has been redecorated and had new carpets throughout, it has a modern refitted kitchen and modern white bathroom, electric heating and double glazed windows. There are communal gardens and allocated car parking to the rear. Available now on an unfurnished basis.

LOCATION FACTS

The property is within easy walking distance of local convenience stores and local schools. There are larger supermarkets also close by as well as DIY stores and additional food outlets. The town centre is only one and a half miles away and offers a wide variety of shopping, leisure and hospitality venues as well as having a mainline rail link to London Marylebone.

DIRECTIONS

Leave High Wycombe on the A40 London Road, pass over two roundabouts and at the second set of traffic lights turn left in to Micklefield Road. Pass over the mini roundabout and take the next turning right in to Herbert Road. The property can be found at the end on the left hand side clearly indicated by the Wye Residential To Let board.

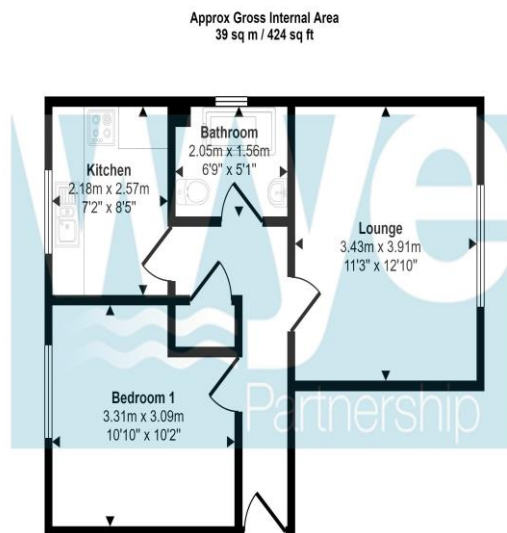

Floorplan

This floorplan is only for illustrative purposes and is not to scale. Measurements of rooms, doors, windows, and any items are approximate and no responsibility is taken for any error, omission or mis-statement. Icons of items such as bathroom suites are representations only and may not look like the real items. Made with Made Snappy 360.

